

October 5th

2005

**KEY LARGO WASTEWATER TREATMENT DISTRICT
BOARD OF COMMISSIONERS**

AGENDA



**Wednesday, October 5, 2005 at 5:00 PM
98880 Overseas Hwy
Key Largo, FL 33037**

**Charles Brooks
Gary Bauman
Andrew Tobin
Glenn Patton
Claude Bullock**

**Chairman
Vice Chairman
Secretary-Treasure
Commissioner
Commissioner**

.....
**Charles F. Fishburn
Thomas Dillon
Carol Walker**

**General Manager
District Counsel
Board Clerk**

PLEASE TAKE NOTICE AND BE ADVISED, that if any interested person desires to appeal any decision of the KLWTD Board, with respect to any matter considered at this meeting, such interested person will need a record of the proceedings, and for such purpose, may need to ensure that a verbatim record of the proceedings is made, which record includes the testimony and evidence upon which the appeal is to be based. Persons with disabilities requiring accommodations in order to participate in the meeting should contact the Board Clerk at 305-451-5105 at least 48 hours in advance to request accommodations.

A. CALL TO ORDER

B. PLEDGE OF ALLEGIANCE

C. ROLL CALL

D. APPROVAL OF AGENDA WITH ANY ADDITIONS OR DELETIONS

E. PUBLIC COMMENT

F. COMMISSIONERS ROUND TABLE

G. COMMISSIONER ITEMS

1. Next Project (Commissioner Patton)

TAB 1

H.	BULK ITEMS	TAB 2
2.	Pending Payments List	
I.	ACTION ITEMS	
3.	Sexton Cove/Lake Surprise Collection System Engineering Work Order	TAB 3
4.	Regional Treatment Plant Engineering Work Order	TAB 4
J.	DISCUSSION ITEMS	
K.	STATUS REPORTS	
5.	Weiler Engineering Status Report	TAB 5
L.	ADJOURNMENT	

KEY LARGO WASTEWATER TREATMENT DISTRICT
Agenda Request Form

Meeting Date: Oct. 5, 2005

Agenda Item No. 1

☐ PUBLIC HEARING

☐ RESOLUTION

☒ DISCUSSION

☐ BID/RFP AWARD

☐ GENERAL APPROVAL OF ITEM

☐ CONSENT AGENDA

☐ Other:

SUBJECT: Next Project

RECOMMENDED MOTION/ACTION: Discussion with approval of work order for Weiler Engineering to be set for the Oct. 19, 2005 meeting.

Approved by General Manager

Date: 9-30-05

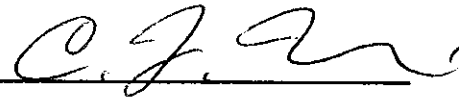

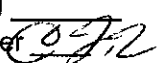
Originating Department: Commissioner Patton	Costs: Approximately \$ Funding Source: MSTU Acct.	Attachments:
Department Review: <input type="checkbox"/> District Counsel <input checked="" type="checkbox"/> General Manager  <input type="checkbox"/> Finance	<input checked="" type="checkbox"/> Engineering <u>EC</u> <input type="checkbox"/> Clerk _____	Advertised: Date: _____ Paper: _____ <input checked="" type="checkbox"/> Not Required
	All parties that have an interest in this agenda item must be notified of meeting date and time. The following box must be filled out to be on agenda.	Yes I have notified everyone _____ or Not applicable in this case _____: Please initial one.

Summary Explanation/Background: Now that the north components project is funded and underway, the Board needs to direct Staff to identify and plan the next project and/or projects.

Resulting Board Action:

☐ Approved

☐ Tabled

☐ Disapproved

☐ Recommendation Revised

KLWTD FUTURE PROJECTS

- ▶ Complete Collection Systems north of the Wastewater Treatment Plant
- ▶ Complete the Vacuum Collection Systems in the vicinity of Vacuum Station at MM 100.5
- ▶ Complete the Transmission Line to southern portion of Key Largo Wastewater Treatment District and connect commercial customers
- ▶ Complete the Collection Systems to the south of the Treatment Plant

C.F.Fishburn
KLWTD
9.30.05

KEY LARGO WASTEWATER TREATMENT DISTRICT
Agenda Request Form

Meeting Date: Oct. 5, 2005

Agenda Item No. 2

☐ PUBLIC HEARING

☐ RESOLUTION

☐ DISCUSSION

☐ BID/RFP AWARD

☒ GENERAL APPROVAL OF ITEM

☐ CONSENT AGENDA

☐ Other:

SUBJECT: Pending Payments list for Oct. 5, 2005

RECOMMENDED MOTION/ACTION: Motion to approve pending payments list for Oct. 5, 2005 contingent upon available funds.

Approved by General Manager

Date: 9-30-05

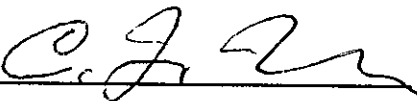

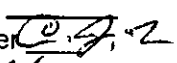
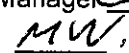
Originating Department: Finance	Costs: \$ Funding Source: Acct. #	Attachments: Will be provided at a latter date
Department Review: <input type="checkbox"/> District Counsel <input checked="" type="checkbox"/> General Manager  <input checked="" type="checkbox"/> Finance 	<input type="checkbox"/> Engineering _____ <input type="checkbox"/> Clerk _____	Advertised: Date: _____ Paper: _____ <input checked="" type="checkbox"/> Not Required
	All parties that have an interest in this agenda item must be notified of meeting date and time. The following box must be filled out to be on agenda.	Yes I have notified everyone _____ or Not applicable in this case _____: Please initial one.

Summary Explanation/Background: The District Finance Officer will E-Mail the Pending Payments list on Monday Oct. 3, 2005.

Resulting Board Action:

☒ Approved

☐ Tabled

☐ Disapproved

☐ Recommendation Revised

KEY LARGO WASTEWATER TREATMENT DISTRICT
Agenda Request Form

Meeting Date: Oct. 5, 2005

Agenda Item No. 3

☐ PUBLIC HEARING

☐ RESOLUTION

☐ DISCUSSION

☐ BID/RFP AWARD

☒ GENERAL APPROVAL OF ITEM

☐ CONSENT AGENDA

☐ Other:

SUBJECT: Sexton Cove/Lake Surprise, etc. Collection System Engineering Work Order proposed by CPH Engineering

RECOMMENDED MOTION/ACTION: Approval

Approved by General Manager

Date: 9-30-05

Originating Department: General Manager Charles Fishburn	Costs: Approximately \$ <u>519,000</u> Funding Source: County Grant and SRF Acct.	Attachments:
Department Review: <input checked="" type="checkbox"/> District Counsel <u>TD</u> <input checked="" type="checkbox"/> General Manager <u>C.F.2</u> <input type="checkbox"/> Finance _____	<input checked="" type="checkbox"/> Engineering <u>EC</u> <input type="checkbox"/> Clerk _____	Advertised: Date: _____ Paper: _____ <input checked="" type="checkbox"/> Not Required
	All parties that have an interest in this agenda item must be notified of meeting date and time. The following box must be filled out to be on agenda.	Yes I have notified everyone _____ or Not applicable in this case _____: Please initial one.

Summary Explanation/Background: CPH Engineering has proposed a work order to provide engineering services required for the collection system in Sexton Cove/Lake Surprise/Ocean Isle Estates/Pamel Villa/Winston Waterways/ Key Largo Campground. Staff has refined and reviewed this work order with CPH Engineers and recommends the scope of this proposal. The entire proposal is in the information package with this meeting book

Resulting Board Action:

☒ Approved

☐ Tabled

☐ Disapproved

☐ Recommendation Revised

KEY LARGO WASTEWATER TREATMENT DISTRICT
Agenda Request Form

Meeting Date: Oct. 5, 2005

Agenda Item No. 4

☐ PUBLIC HEARING

☐ RESOLUTION

☐ DISCUSSION

☐ BID/RFP AWARD

☒ GENERAL APPROVAL OF ITEM

☐ CONSENT AGENDA

☐ Other:

SUBJECT: Regional Treatment Plant Engineering Service Work Order

RECOMMENDED MOTION/ACTION: Approval

Approved by General Manager

Date: 9-30-05

Originating Department: General Manager Charles Fishburn	Costs: Approximately \$742,000 Funding Source: County Grant and SRF Acct.	Attachments:
Department Review: <input checked="" type="checkbox"/> District Counsel <u>TD</u> <input checked="" type="checkbox"/> General Manager <u>CFB</u> <input type="checkbox"/> Finance _____	<input checked="" type="checkbox"/> Engineering <u>EC</u> <input type="checkbox"/> Clerk _____	Advertised: Date: _____ Paper: _____ <input checked="" type="checkbox"/> Not Required
	All parties that have an interest in this agenda item must be notified of meeting date and time. The following box must be filled out to be on agenda.	Yes I have notified everyone _____ or Not applicable in this case _____: Please initial one.

Summary Explanation/Background: Arcadis and MWH have proposed the engineering for the Regional Treatment Plant, and Deep Injection Wells. Staff has refined the proposal with Arcadis/MWH and recommends the proposed scope of work included in the information package.

Resulting Board Action:

☐ Approved

☐ Tabled

☐ Disapproved

☐ Recommendation Revised

KEY LARGO WASTEWATER TREATMENT DISTRICT

Agenda Request Form

Meeting Date: Oct. 5, 2005

Agenda Item No. 5

☐ PUBLIC HEARING

☐ RESOLUTION

☒ DISCUSSION

☐ BID/RFP AWARD

☐ GENERAL APPROVAL OF ITEM

☐ CONSENT AGENDA

☐ Other:

SUBJECT: Projects Status Report

RECOMMENDED MOTION/ACTION: No action required

Approved by General Manager 

Date: 9-30-05

Originating Department: Weiler Engineering	Costs: \$ Funding Source: Acct. #	Attachments: Will be provided at a latter date.
Department Review: <input type="checkbox"/> District Counsel <input checked="" type="checkbox"/> General Manager <u>TOF</u> <input type="checkbox"/> Finance	<input checked="" type="checkbox"/> Engineering <u>EC</u> <input type="checkbox"/> Clerk	Advertised: Date: _____ Paper: _____ <input checked="" type="checkbox"/> Not Required
	All parties that have an interest in this agenda item must be notified of meeting date and time. The following box must be filled out to be on agenda.	Yes I have notified everyone _____ or Not applicable in this case _____ Please initial one.

Summary Explanation/Background: The District Engineer will review the status of the District's Capital Projects. Commissioners will receive the report by E-mail Monday Oct. 3, 2005.

Resulting Board Action:

☐ Approved

☐ Tabled

☐ Disapproved

☐ Recommendation Revised

P.O. Box 491 Key Largo, FL 33037
Phone: 305-453-5804
Fax: 305-453-5807

**Key Largo
Wastewater
Treatment District**

Memo

To: KLWTD Board
From: Carol Walker, CMC
CC: Staff
Date: October 5, 2005
Re: TAB 2

The attached is the pending payments list for October 5, 2005 TAB 2

Key Largo Wastewater Treatment District

Payments Pending 10/05/05

Prepared 10/03/05

CONSOLIDATED CASH BALANCE FORWARD

\$ 629,404.94

Administration & Operations

Cash Balance A&O Account Forward	\$ 96,194.70	
Plus: MSTU Draw #11	45,334.25	
Less: BellSouth - Rollover Lines & Office Line	110.28	
Sprint - Cell Phones	153.27	
PRMG - SRF Loan Appl. & Misc.	749.13	
GSG - Assessment Roll Development	450.00	
FMIT - Quarterly Insurance Premium	12,306.00	
Upchurch, W, W & M - Mediation Fee	2,433.33	
MC Court Reporters - Haskell Settlement Meeting	137.50	
Heidi Herzog - Clerk Vacation Coverage	277.50	
Toshiba - Copier Expense	468.79	
Chris Sante - Office Rent (October)	2,450.00	
Comcast - Cable Service	31.28	
Office Depot - MS Office (2@\$500), Printer (\$300), Misc.	2,963.88	
Nissan - Truck Lease	219.00	
Tom Dillon - Legal Services	1,281.50	
Premier Global Service - CPH Conference Calls (2)	93.86	
Federal Express - Deliveries	226.57	
VISA - Pipe Insp. Camera (\$6,500), Fuel, Misc.	7,819.17	
Paychex - September Fee	100.12	
FKEC - Office Electric (3 mos. "B" / 1 mo. "A")	619.00	
Sub-total Invoices	32,890.18	
		\$ 12,444.07
Cash Balance A&O Account If All Paid	\$ 108,638.77	
Memo: MSTU Draw #12 Submitted 9/7/05 \$65,288		

Key Largo Park

Cash Balance KLP Account Forward	\$ (32,878.93)	
Less: Weiler Engineering - September	3,022.29	
		(3,022.29)
Cash Balance KLP Account If All Paid	\$ (35,901.22)	
Memo: MC Cesspit Draw #1 Submitted 7/22/05 \$ 17,464		

Key Largo Trailer Village

Cash Balance KLTV Account Forward	\$ (422,822.20)	
Less: Tom Dillon - Legal Services	6,788.00	
Weiler Engineering - September	5,656.78	
Haskell - August	367,282.77	
Sub-total Invoices	379,727.55	
		(379,727.55)
Cash Balance KLTV Account If All Paid	\$ (802,349.75)	
Memo: FEMA Draw #8 Submitted 7/20/05 \$ 933,518		
DCA Cesspit Draw #1 Submitted 7/22/05 \$ 654,049		
FEMA Draw #9 (Final) Submitted 8/02/05 \$ 8,373		

North Key Largo Development

Cash Balance KLNC Account Forward	988,711.37	
Less: Tom Dillon - Legal Services	994.00	
Weiler Engineering - September	2,583.15	
		(3,577.15)
Cash Balance KLNC Account If All Paid	985,134.22	

CONSOLIDATED CASH BALANCE IF ALL PAID

\$ 255,522.02

NOTE: A TOTAL OF \$ 1,678,692 REQUESTED FOR REIMBURSEMENT IS OUTSTANDING

Approved for payment:

Charles Brooks, Chairman

Andrew Tobin, Secretary

Memo

To: KLWTD Board
From: Carol Walker, CMC
CC: Staff
Date: October 5, 2005
Re: TAB 2 and TAB 3

The attached is additional information for TAB 3 and TAB 4

Commercial Connections Along US-1 Corridor

Includes hotels, RV parks, Trailer Parks, Marinas, Etc. that have existing WWTPs and collection system.

1383 EDUs (based on flow, where 167 GPD = 1 EDU)

- This represents the minimum number of EDUs. Actual number of EDUs will be larger, depending on definitions adopted by KLWTD. Could be as much as double this number.

Summary

	SBR	ENR & SURVEY	
■ WWTP site costs -	\$17.6 M	15.2	742,000 5%
■ Force Main costs -	\$4.8 M		208,000 4.3%
■ Lake Surprise area -	\$6.8 M		579,000 4.6%
■ Largo Gardens area -	\$4.5 M		239,000 E 6.4%
■ Design & Permitting -	\$1.8 M		
	31.3M	1.7M	5.4%

TOTAL: \$35.5 M

Note: A 15% (\$5 M) contingency fund on construction costs should be budgeted

Memo

To: KLWTD Board
From: Carol Walker, CMC
CC: Staff
Date: October 5, 2005
Re: TAB 3

The attached is the maps that are referred to in the Collection System Design Scope Section 1 – General on page 1 of the additional information for TAB 3 in your Info Package.

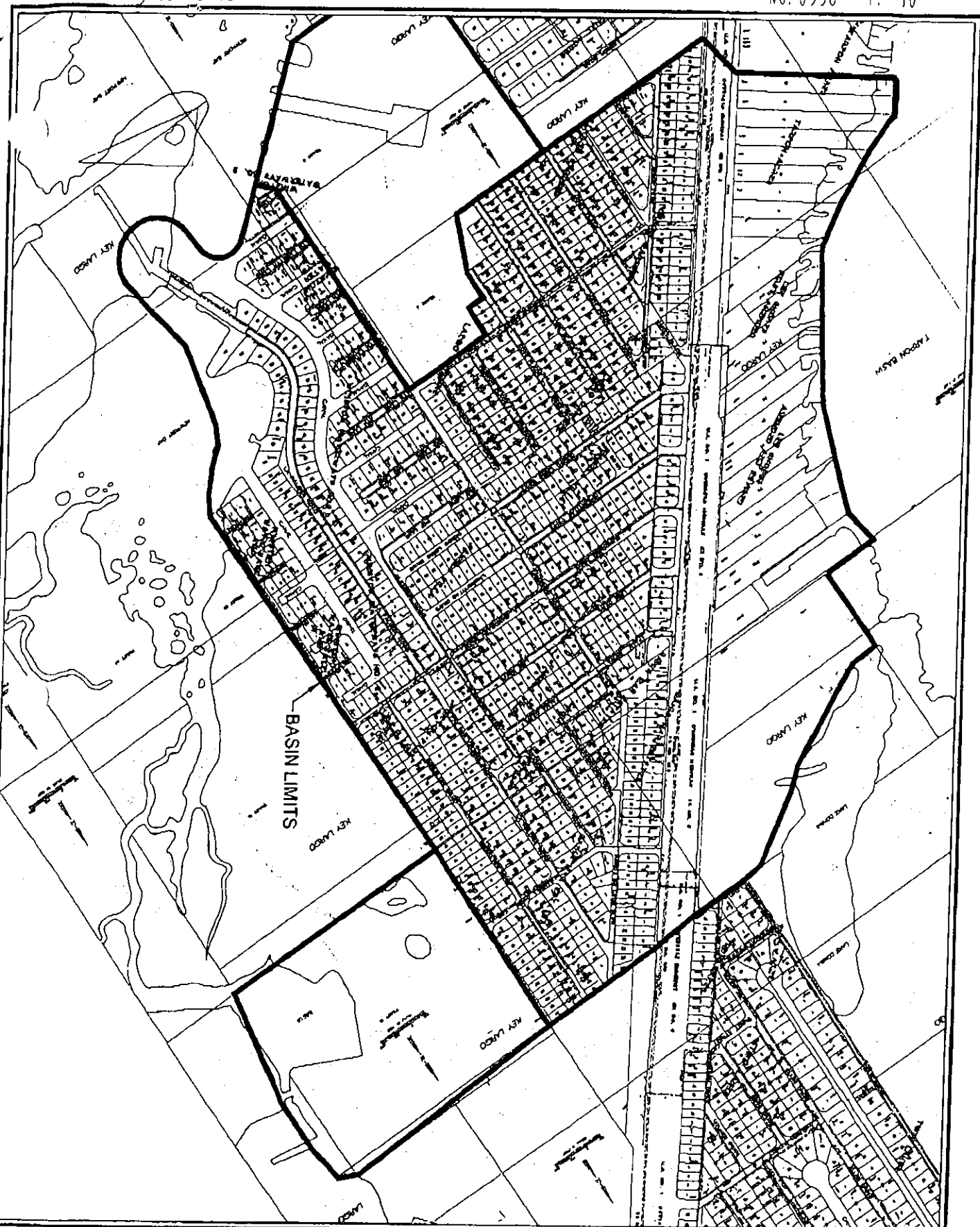

cph
 Engineers
 Surveyors
 Planners/Landscape Architects
 Environmental Scientists
 Construction Management
 10 10 10 . c p h e n g i n e e r s . c o m
 1117 East Robbman Street, Orlando, FL 32801
 Phone 407.426.0452 Fax 407.648.3036

Scale: 1" = 700'
 Date: 08-01-2005
 Job No.: K3001
 Certificate of Authorization
 No. 3713

BASIN MAP
CLIENT
KEY LARGO FM AND LIFT STATION

FIGURE
 1

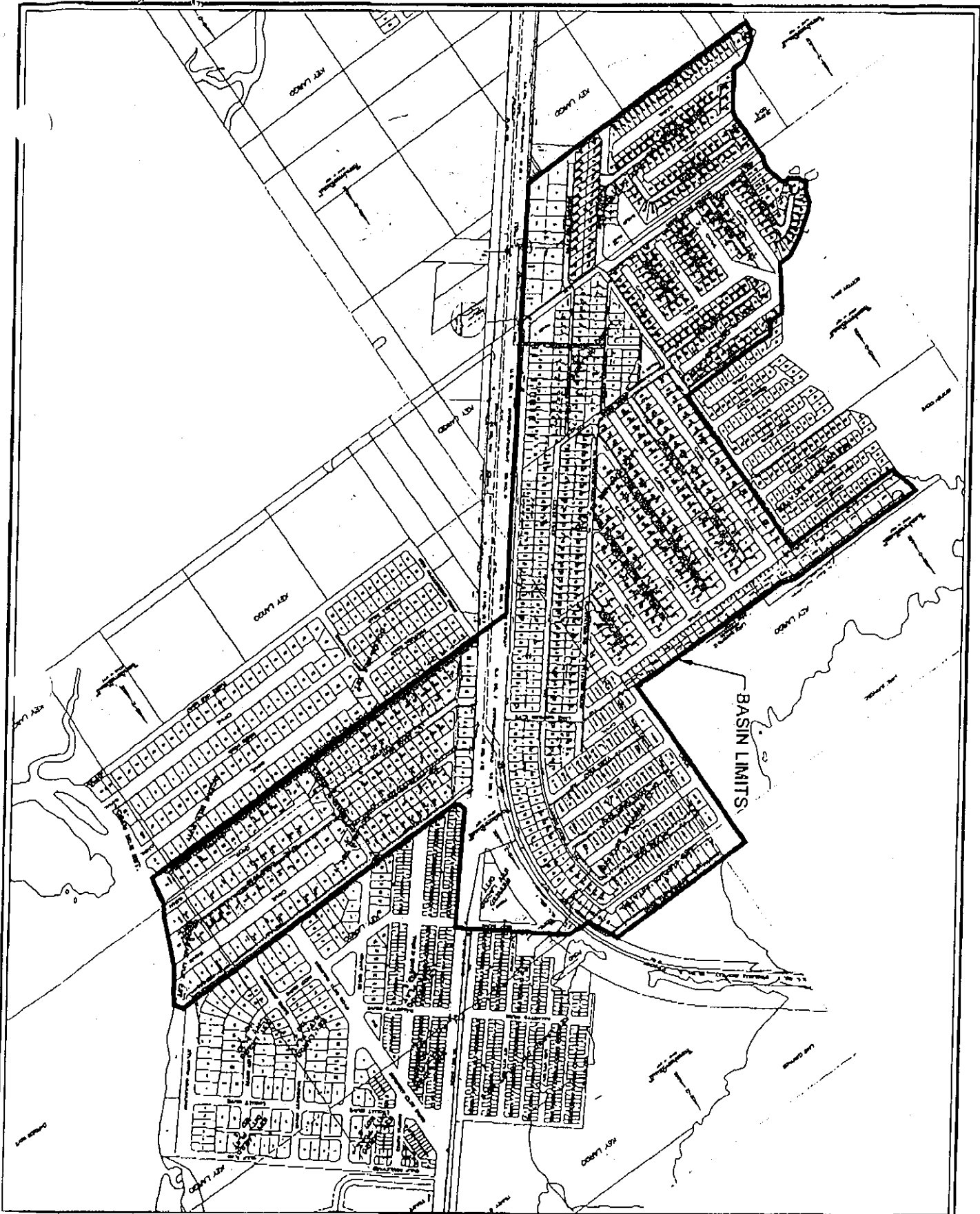

cpH
 Engineers
 Surveyors
 Planners / Landscape Architects
 Environmental Scientists
 Construction Management
 www.cphengineers.com
 1117 East Robinson Street, Orlando, FL 32803
 Phone 407.625.0152 Fax 407.648.1036

Scale: 1" = 800'
 Date: 08-01-2005
 Job No.: K3001
 Certificate of Authorization
 No. 3215

BASIN MAP
CLIENT
KEY LARGO FM AND LIFT STATION

FIGURE
2

P.O. Box 491 Key Largo, FL 33037
Phone: 305-453-5804
Fax: 305-453-5807

**Key Largo
Wastewater
Treatment District**

Memo

To: KLWTD Board
From: Carol Walker, CMC
CC: Staff
Date: October 5, 2005
Re: TAB 5

The attached is the status report from Weiler Engineering for TAB 5.

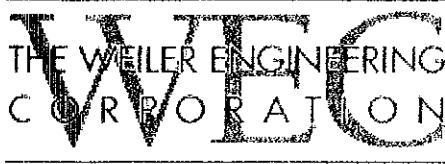

"Excellence in Engineering"

20020 Veterans Boulevard., Suite 7
Port Charlotte, FL 33954
(941) 764-6447 ph
(941) 764-8915 fax

Key Largo Wastewater Treatment District Engineering Status Report Period Ending 09/30/05

Key Largo Park

Trenching continued in the Key Largo Park and vacuum main was placed on Lauderdale Drive. ADB brought in a sub, Pabone Engineering, to excavate and lay pipe.

The new style Airvac pits were received. Bill Mouldin, the Airvac field representative, arrived for his four week service period. Clint Hawn of Airvac also came down to observe the new style pits being installed. One was installed, but several failed the pre-placement pressure test and a number of others failed visual inspection by the Airvac representatives. Installation of the new pits was put on hold while the problem is being investigated. Installation of the old style pits is being carried on.

Key Largo Trailer Village

Cleanup and restoration continued in September. The transition from the HDPE pipe used in the US 1 crossing to the PVC used throughout the rest of the project was accomplished and the run of three 10-inch pipes from US 1 into the vacuum tank at the WWTP site began.

KLTV Treatment Plant

Work at the treatment plant progressed with the piping in of the vacuum pump skid and other components of the vacuum pump station. Coatings were applied to the administration/motor control center building. The electrical and plumbing work progressed throughout the month.

Ted Hortenstine of Brown and Caldwell worked on the wastewater treatment plant Operation and Maintenance Manual in September. He has the Fluidyne and miscellaneous equipment information in hand and was expecting delivery of the Airvac manuals shortly. He is also contacting the Florida Rural Water Association to request a copy of their guidance document for preparation of Operation and Maintenance Manuals.

Submittals for coatings and miscellaneous deliverables were received in September. WEC pointed out the Brown and Caldwell that the anchors for the Fluidyne tanks needed to be designed for the combined wind and buoyancy loads rather than each one separately. As a result, the anchors are being beefed up. The new anchors will be galvanized as specified for the miscellaneous metals rather than epoxy coated as proposed.

Lake Surprise Project

Design of the north component force main progressed in September. Several conference calls were held with CPH staff, District staff and WEC staff. CPH continued the hydraulic modeling of the force main system. The 30% design of the force main was submitted at the end of September and is currently under review by WEC and District staff.

The CPH proposal for the design of the collection systems for the Lake Surprise basin and the Largo Gardens basin was revised and pricing was negotiated. An acceptable scope and price for the design of the tow collection basins was reached and is recommended for approval. The pricing for the survey was too high, and that pricing is still under negotiation.

Through several conferences with Arcadis, MWH, WEC and District staff, the scope of work for the design and permitting of the wastewater treatment plant achieved an acceptable degree of detail. Both specific technical assumptions and level of effort by the designers was submitted. The position of Arcadis/MWH has been that they can not accurately provide their pricing until further details of the work are designed. After consultations with all parties and with District Counsel, it was decided to change the form of the proposed work authorization to an hourly task with a not-to-exceed total. It was also agreed that after the conceptual design stage was completed, the not-to-exceed pricing would be revisited with the intent of looking for reductions in cost.

Haskell Pay Applications

Payment of Haskell Pay Application No. 23 was submitted in September, but a number of adjustments were needed. As a result, the application was not approved by WEC until the end of the month. Pay Application No. 23 is now complete and will be submitted on the Payments Pending list for the October 3rd Board meeting.

Regulatory Compliance Issues

The Environmental Resources Permit has been provided to WEC. With the exception of final certifications and approval for use, this should complete the permitting processes.

Project Team Meetings and Actions

Ed Castle attended the scheduled Board meetings on September 7th and 21st. He also met with KLWTD staff on those dates prior to the Board meetings. He also attended the construction progress meetings for Key Largo Park on and also attended the weekly District Staff meetings either in person or by telephone. He also attended design review conference calls with CPH and District staff.

Ed Castle and Dave Gile of WEC performed construction inspection throughout the period.

Memo

To: KLWTD Board
From: Carol Walker, CMC
CC: Staff
Date: October 5, 2005
Re: TAB 1

The attached additional information for TAB 1.

KLWTD WASTEWATER PROJECTS

	HOT SPOTS	EDU'S	COST (MILLIONS)
KLTV & KLP Current Projects	4, 27	1000	\$13
North Components include Regional Treatment Plant & Transmission Line	2, 19	2500	\$35-38
Complete Collection Systems north of the Wastewater Treatment Plant	7, 15, 29	3500	\$28-35
Complete the Vacuum Collection Systems in the vicinity of Vacuum Station at MM 100.5	17	300	\$3-4
Complete the Transmission Line to southern portion of Key Largo Wastewater Treatment District and connect commercial customers		2000	\$8-10
Complete the Collection Systems to the south of the Treatment Plant	5, 9, 20 21, 24	4000	\$35-40
TOTALS	2, 4, 7, 9, 12, 15, 17, 19, 20, 21, 24, 27, 29 Thirteen of 45 Hot Spots in Master Plan	13,300	\$122 - \$140

CFF 10/04/05

APPENDIX F
EXHIBIT F-6

Tavernier/Key Largo Regional Wastewater Management District Phasing

MASTER PLAN VOL. II

Service Area Phase	Project Description	Hot Spot Rank Within Region	Project Contribution						WWTP Capacity (mgd)				Total Project Cost Collection, Transmission & Treatment				Annual O & M		Total Annual Cost (\$)		Cost Per EDU	
			ADF (mgd)		WWTP Design Capacity (mgd)		EDU		Unknown Systems		Phase Design Capacity	Cumul Project	Cumul Project	Cumul Annualized	Cumul Project	Vacuum Stat	Cumul	Total Annual Cost (\$)	Annual (\$)	Monthly (\$/EDU)		
			Project	Cumul	Project	Cumul	Project	Cumul	Project	Cumul												
1	Lake Surprise/Sexton Cove, Ocean Isle Estates, and area adjacent to U.S. 1 ¹	1	0.123		0.165		858		389	389												
2	Key Largo Trailer Village, Largo Gardens, Hibiscus Park, and area adjacent to U.S. 1 ¹	2	0.121		0.164		904		520	909												
3	Cross Key Waterway Estates, Largo Sound Park, Anglers Park Shores, south Creek Village, and area adjacent to U.S. 1 ¹	3	0.104		0.140		775		285	1,194												
6	Remainder of PAED 19/20 - Stillwright Point, Paradise Point Cove, Riviera Village, Key Largo Mobile Home Sites, Largo City Also includes the construction of the first phase of the regional wastewater transmission and treatment facility	7	0.314	0.662	0.050	0.810	1,722	4,259	292	1,486												
7	Port Largo, Key Largo Beach, Key Largo Ocean Shores, Silver Lake Park, Holiday Homesites, Bultwood Shores, Bultwood Cove, Lazy Lagoon, Point Pleasant Sunset Cove	8	0.189	0.85	0.98		1,210	5,469	191	1,677	1.50	1.50										
8	Bahia Mar Estates, Pamela Villa, Winston Waterways	10	0.042	0.692	1.02	314	5,783		63	1,740	1.50											
9	Pirate's Cove, Rock Harbor Estates, Marion Park, Rock Harbor Manor Harbor Shores, Elstorado	11	0.138	1.03	1.18	890	6,673		120	1,860	1.50											
10	Bay Haven, Lime Grove Estates, Sunrise Point, Abode Casa Court, Seven Acres, Sunset Gardens, Dove Creek	12	0.058	1.088	1.25	505	7,178		129	1,989	1.50											
5A	Deactivate Hams Ocean Park, Palma Sol, Sherrill Park, Hammer Point Park Community WWTP and connect into Regional System ¹	5	0.083	1.171	1.35	661	7,839		212	2,201	1.50											
11	Old Tavernier	14	0.148	1.319	1.52	1,187	9,026		110	2,311	0.75											
12	Sunset Waterways, Key Largo Park	15	0.088	1.376	1.58	367	9,393		40	2,351	2.25											
13	Bermuda Shores, Twin Lakes	16	0.040	1.416	1.63	296	9,680		54	2,405	2.25											
14	Existing WWTPs	...	0.374	1.79 ²	2.06 ²	2,746	12,435		...	2,405	2.25											

¹Community wastewater collection and treatment system will serve this Hot Spot area initially, until regional system becomes available to serve this area

²Flow contributions maintained at 1998 levels as the rate of implementation over the 20-year planning period is unknown

Wastewater flows in this regional service area are projected to increase about 9.1/2% over the 20-year planning period 1998 - 2018. Thus, the 1.79 mgd ADF would be about 1.96 mgd in 2018, and the 1.99 mgd WWTP flow would be about 2.25 mgd in 2018

EXHIBIT 6-3

Hot Spot Areas and Rankings - Upper Keys

Study Area

No.	Name	Wastewater Service Area	Hot Spot Area Name	Area Rank by Region	Rank for Entire Keys
24	PAED 19/20	Tavernier/Key Largo Regional	Lake Surprise/Sexton Cove, Ocean Isle Estates, and adjacent area on U.S. 1	1	2
23	PAED 18	Tavernier/Key Largo Regional	Key Largo Trailer Village, Largo Gardens, Hibiscus Park, and area adjacent to U.S. 1	2	4
23	PAED 18	Tavernier/Key Largo Regional	Cross Key Waterway Estates & Largo Sound Park/Anglers Park Shores/South Creek Village and area along U.S. 1	3	7
21	PAED 16	Tavernier/Key Largo Regional	Area A, Wynken, Blyken & Nod	4	9
20	PAED 15	Tavernier/Key Largo Regional	Harris Ocean Park, Palma Sola, Sherrill Park, Hammer Point Park, and along U.S. 1	5	12
19	Plantation Key	Islamorada Regional	Area A - Eastern end of Plantation Key including Plantation Key Colony/Kahiki Harbor/Edenraire/Tavernier/ Tropical Atlantic Shores	6	14
24	PAED 19/20	Tavernier/Key Largo Regional	Remainder of PAED 19/20 - Stillwright Point/Paradise Point Cove, Riviera Village, Key Largo Mobile Home Sites, Largo City	7	15
22	PAED 17	Tavernier/Key Largo Regional	Port Largo, Key Largo Beach, Key Largo Ocean Shores, Silver Lake Park, Holiday Homesites, Buttonwood Shores, Buttonwood Cove, Lazy Lagoon, Point Pleasant Sunset Cove	8	17
16	Lower Matecumbe	Lower Matecumbe	Safety Harbor, Toll Gate Shore, Port Antigua, White Marlin Beach, Matecumbe Sandy Beach, Lower Matecumbe Beach	9	18
23	PAED 18	Tavernier/Key Largo Regional	Bahia Mar Estates/Pamela Villa/Winston Waterways	10	19
22	PAED 17	Tavernier/Key Largo Regional	Pirate's Cove, Rock Harbor Estates, Marion Park, Rock Harbor Manor, Harbor Shores, El Dorado	11	20
21	PAED 16	Tavernier/Key Largo Regional	Bay Haven, Lime Grove Estates, Sunrise Point, Abode Casa Court, Seven Acres, Sunset Gardens, Dove Creek	12	21
17	Upper Matecumbe	Islamorada Regional	Entire Study Area	13	22
20	PAED 15	Tavernier/Key Largo Regional	Old Tavernier	14	24
22	PAED 17	Tavernier/Key Largo Regional	Sunset Waterways, Key Largo Park	15	27
23	PAED 18	Tavernier/Key Largo Regional	Bermuda Shores, Twin Lakes	16	29
19	Plantation Key	Islamorada Regional	Venetian Shores	17	30
18	Windley Key	Islamorada Regional	Entire Study Area	18	32
19	Plantation Key	Islamorada Regional	Treasure Harbor, Plantation Ridge Coral Shores	19	33
19	Plantation Key	Islamorada Regional	Indian Waterways, Indian Harbor, Plantation Key, Lysiloma, Key Heights, Vacation Village, Aergood Heights, Pearl City	20	37
19	Plantation Key	Islamorada Regional	Remainder of Plantation Key	21	38

Potential WWTP Sites

Tavernier

PAED 15

(S.A. 20)

HOT SPOTS
12, 24

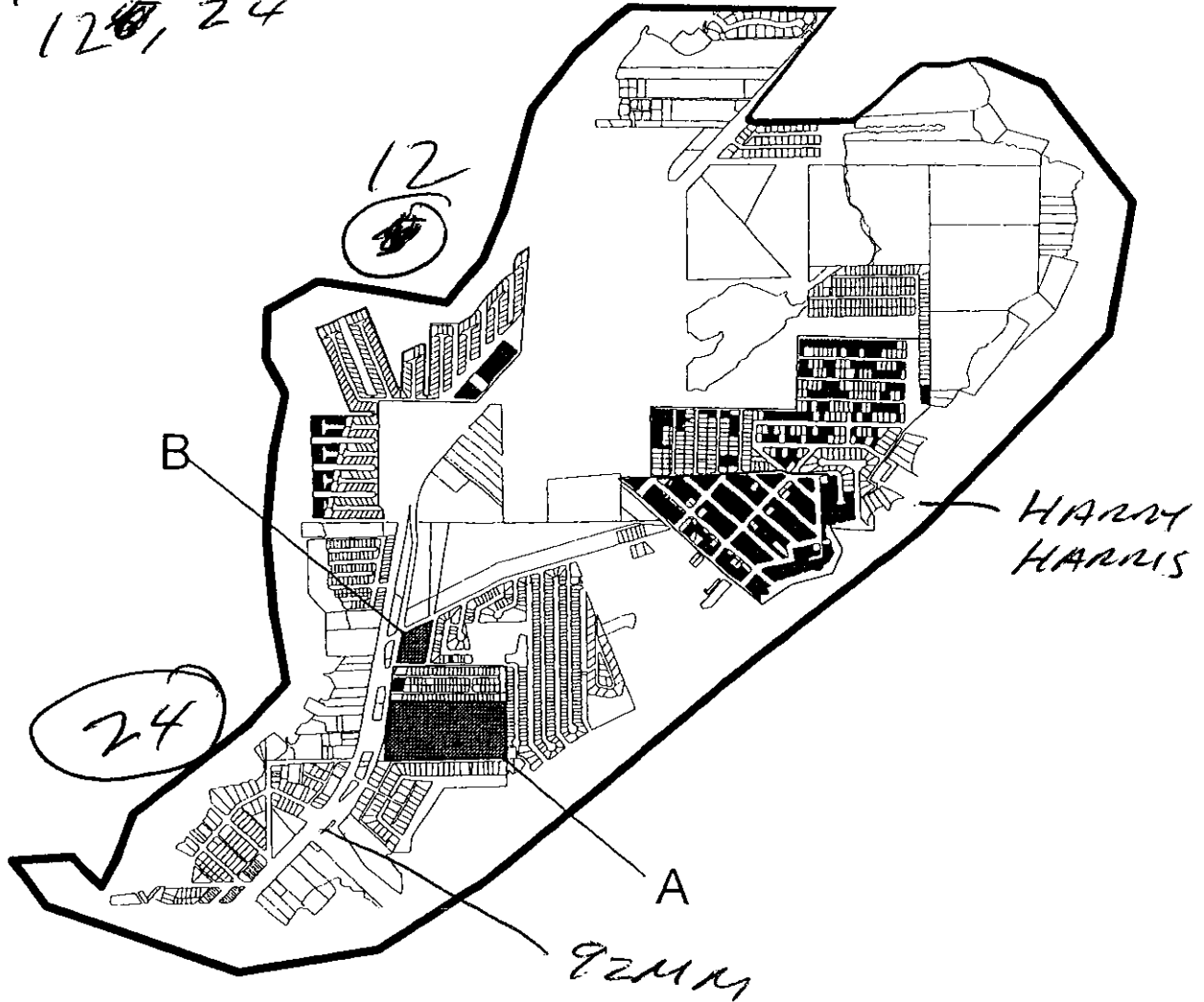

1858 RESIDENTIAL EDU'S
576 COMM. EDU'S

2434 TOTAL EDU'S.

0 2000 Feet

Legend

- Boundary of Potential Hotspot
- Potential WWTP Site (Large)
- Potential Vacuum Station Site or WWTP Site (Small)
- Parcel

Potential WWTP Sites
Tavernier PAED 15 - Study Area 20
Sanitary Wastewater Master Plan Team
Morroe County, Florida
Planning For A Better Environment

CH2M HILL • AGS Associates • Continental Staff Associates Inc.
Hazen and Sawyer • R. Kelly, R. Kelly, Hargis,
Alderman, Rogers, and Tan
Lynchki Planning, Design, & Construction Inc.

Potential WWTP Sites

Rock Harbor

PAED 16

(S.A. 21)

HOT SPOTS
9, 21

96MM

9

21

Silver
Shores

1201 RES. EDU'S
438 COMM. EDU'S

1639 TOTAL EDU'S



0 2000 Feet

Legend

- Boundary of Potential Hotspot
- Potential WWTP Site (Large)
- Potential Vacuum Station Site or WWTP Site (Small)
- Parcel

June 2000

Potential WWTP Sites
Rock Harbor PAED 16 - Study Area 21
Sanitary Wastewater Master Plan Team
Monroe County, Florida
Planning for a Better Environment

CH2M HILL • Ayres Associates • Continental Shale Associates, Inc.
Hines and Souper • K&E, Inc. • Mager
Anderson, Beyer and Fox
Lundell, Browning, Peters & Haddad, Inc.

Potential WWTP Sites

Key Largo

PAED 17

(S.A. 22)

HOT SPOTS

17, 20, 24

1840 RESIDENTIAL EDU'S

1272 COMM. EDU'S

3112 TOTAL EDU'S

KLP 100.5 MM
TREATMENT
PLANT

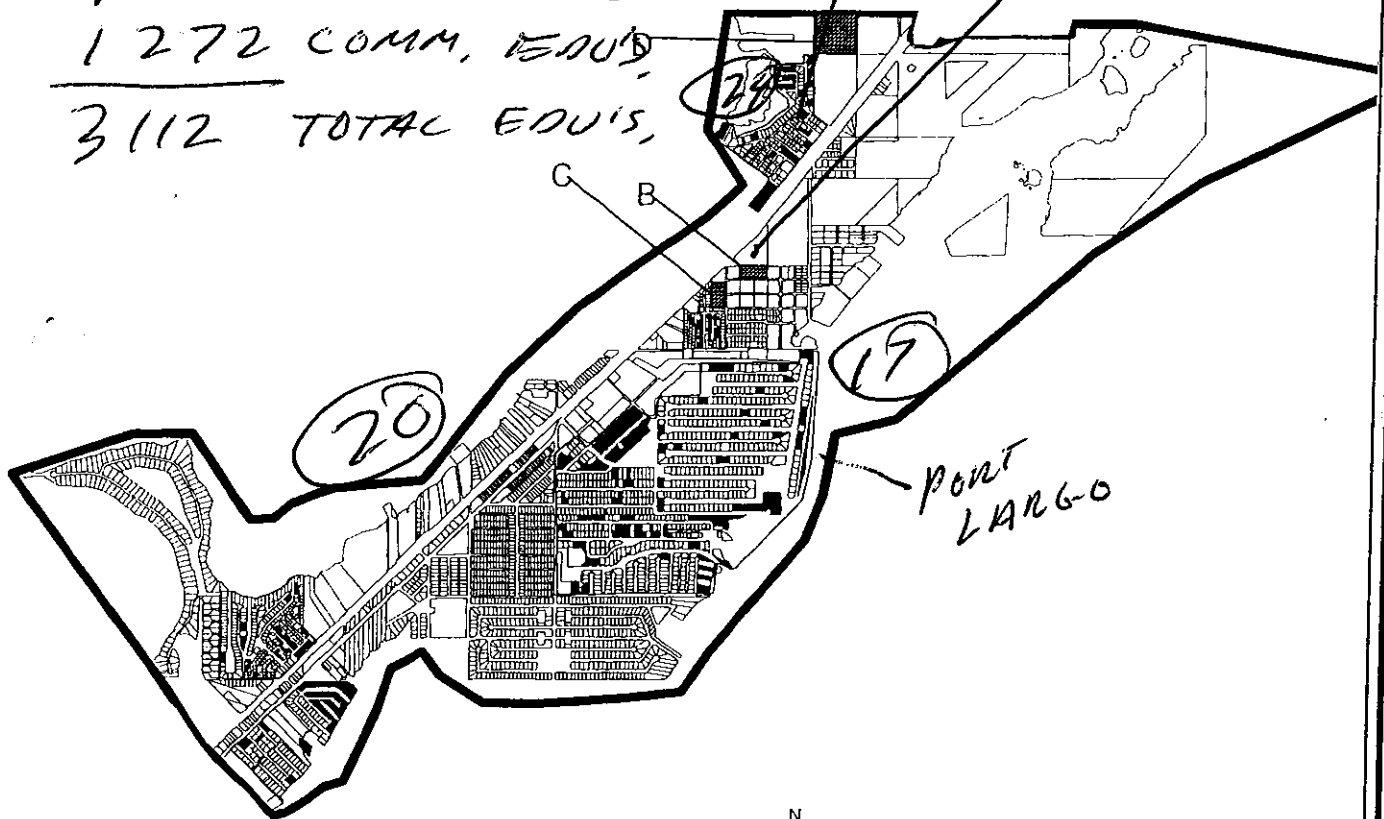

Legend

- Boundary of Potential Hotspot
- Potential WWTP Site (Large)
- Potential Vacuum Station Site or WWTP Site (Small)
- Parcel

Potential WWTP Sites
Key Largo PAED 17 - Study Area 22
Sanitary Wastewater Master Plan Team
Marion County, Florida
Planning for a Better Environment
CH2M HILL • Ayres Associates • Continental Shelf Associates Inc.
Hazen and Sawyer • Kari, Kohn, Hagler,
Anderson, Ryland and Fox
Lindquist, Browning, Fennell & Hightower Inc.

Potential WWTP Sites

Key Largo
PAED 18
(S.A. 23)



0 2000 Feet

HOT SPOTS,
4, 7, 19, 29

→ 1725 TO SERVE.
2175 RES. EDU
644 COM. EDU

2824 TOTAL EDU.
- 450

2374 TO BE
COMPLETED

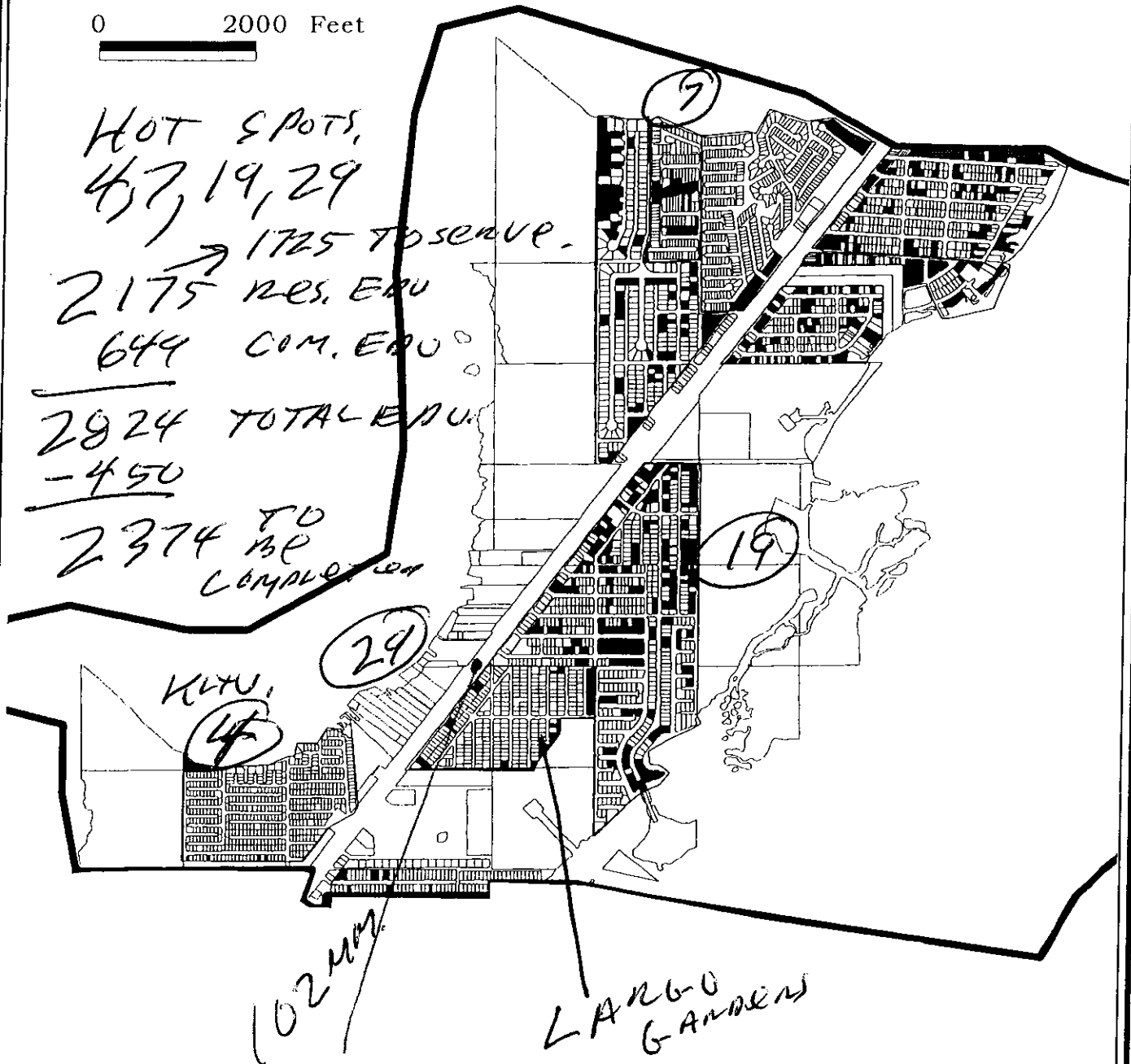

Legend

- Boundary of Potential Hotspot
- Potential WWTP Site (Large)
- Potential Vacuum Station Site or WWTP Site (Small)
- Parcel

Potential WWTP Sites
Key Largo PAED 18 - Study Area 23
Sanitary Wastewater Master Plan Team
Monroe County, Florida
Planning For A Better Environment

CH2M HILL ■ Ayres Associates ■ Environmental Staff Associates, Inc.
Hazen and Sawyer ■ T&E ■ K&M ■ H&M
Alderman, Rogers and Pao
Lindahl, Brunning, Petric, & Mulliken, Inc.

June 2000

Potential WWTP Sites

Key Largo
PAED 19 & 20
(S.A. 24)

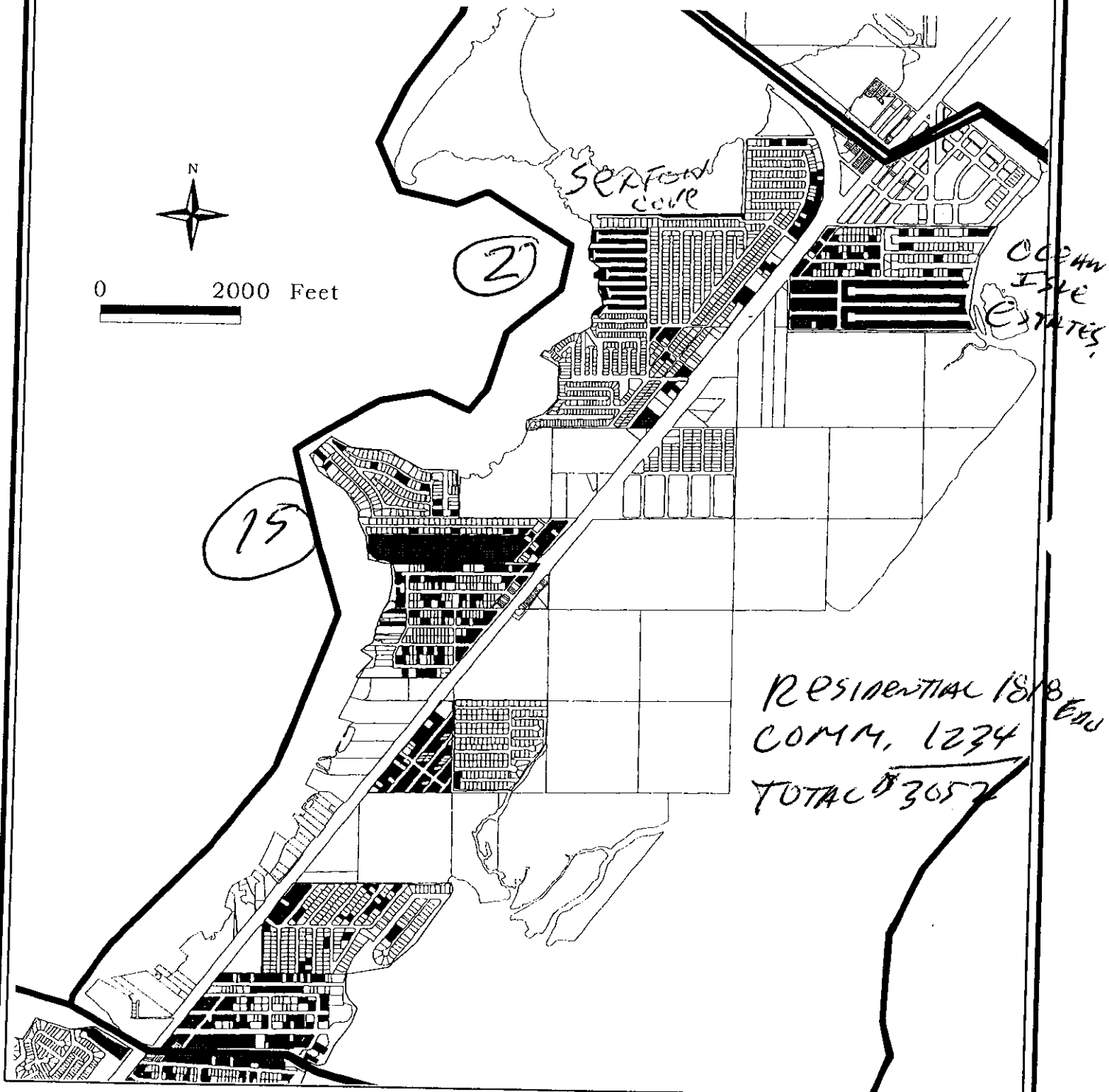

Legend

- Boundary of Potential Hotspot
- Potential WWTP Site (Large)
- Potential Vacuum Station Site or WWTP Site (Small)
- Parcel

June 2000

Potential WWTP Sites
Key Largo PAED 19 & 20 - Study Area 24
Sanitary Wastewater Master Plan Team
Monroe County Florida
Planning For A Better Environment
CH2M HILL • Aqua Associates • Continental Shift Associates Inc.
Hazen and Sawyer • E. Paul Kline, Inc. • Hargrett
Adelman, Bryant and Fox
Lindberg, Browning, Feltner, & Holliman, Inc.

MASTER PLAN, VOL. II

APPENDIX E EXHIBIT E-2

Combinations of Study Areas Significant to Formulating Master Plan Recommendations

Study Area Combinations	Wastewater System Design Flow (mgd)	Monthly Cost per EDU by Combining (\$/EDU/Mo)	Weighted Study Area Monthly Cost per EDU (\$/EDU/Mo)(1)	Cost Savings by Combining		Remarks
				Yes/No (2)	% (3)	
1, 2 Stock Island, Boca Chica	0.90	127	85	No	+69	Effluent disposal by shallow injection wells for both individual study areas and combination of study areas. If effluent disposal were by deep injection wells for combination of study areas, combination cost would increase by \$14/EDU/Mo, or 49 percent greater than weighted monthly cost.
2, 3 Boca Chica, Bay Point	0.41	118	101	No	+17	
3, 4 Bay Point, Lower Sugarloaf	0.22	133	121	No	+10	
1, 2, 3, 4, 5, 6, 7 Stock Island, Boca Chica, Bay Point, Lower Sugarloaf, Upper Sugarloaf, Cudjoe, Summerland	1.27	147	100	No	+47	Effluent disposal by shallow injection wells for individual study areas. For combinations Florida Statute requires effluent disposal by deep injection wells. Deep injection wells increase annual costs by \$438,000, or about \$5/EDU/Mo.
3, 4, 5, 6, 7 Bay Point, Lower Sugarloaf, Upper Sugarloaf, Cudjoe, Summerland	0.71	119	110	No	+8	Effluent disposal by shallow injection wells for both individual study areas and combination of study areas. If effluent disposal were by deep injection wells for combination of study areas, combination cost would increase by \$11/EDU/Mo, or 18 percent greater than weighted monthly cost.
5, 6, 7 Upper Sugarloaf, Cudjoe, Summerland	0.49	112	107	No	+5	
5, 6 Upper Sugarloaf, Cudjoe	0.33	102	102	-	0	
6, 7 Cudjoe, Summerland	0.41	105	102	No	+3	
9, 10, 11 Ramrod, Little Torch, Big Pine	0.81	112	115	Yes	-3	Effluent disposal by shallow injection wells for both individual study areas and combination of study areas. If effluent disposal were by deep injection wells for combination of study areas, combination cost would increase by \$10/EDU/Mo, or 9 percent greater than weighted monthly cost.
9, 10 Ramrod, Little Torch	0.22	137	131	No	+4	
11 Little Torch, Big Pine	0.72	108	112	Yes	-3	Effluent disposal by shallow injection wells for both individual study areas and combination of study areas. If effluent disposal were by deep injection wells for combination of study areas, combination cost would increase by \$11/EDU/Mo, or 10 percent greater than weighted monthly cost.
16, 17, 18, 19 Lower Matecumbe, Upper Matecumbe, Windley, Plantation	1.49	80	79	No	+1	Wastewater treatment plant within service area. Effluent disposal by shallow injection wells for individual study areas. For combinations Florida Statute requires effluent disposal by deep injection wells. Deep injection wells increase annual costs by \$438,000, or about \$4/EDU/Mo.
17, 18, 19 Upper Matecumbe, Windley, Plantation	1.29	73	74	Yes	-1	Wastewater treatment plant within service area. Effluent disposal by shallow injection wells for individual study areas. For combinations Florida Statute requires effluent disposal by deep injection wells. Deep injection wells increase annual costs by \$438,000, or about \$5/EDU/Mo.
20, 21, 22, 23, 24 Tavernier (PAED 15), Rock Harbor (PAED 16), PAED 17, PAED 18, PAED 19/20	2.06	70	79	Yes	-11	Wastewater Treatment Plant within service area. Effluent disposal by shallow injection wells for individual study areas. For combinations Florida Statute requires effluent disposal by deep injection wells. Deep injection wells increase annual costs by \$438,000, or about \$3/EDU/Mo.
20, 21, 22, 23, 24 Tavernier (PAED 15), Rock Harbor (PAED 16), PAED 17, PAED 18, PAED 19/20	2.06	85	79	No	+8	Wastewater transmitted out of Keys to Miami-Dade
20, 21, 22, 23, 24, 27 Tavernier (PAED 15), Rock Harbor (PAED 16), PAED 17, PAED 18, PAED 19/20, Ocean Reef Club	2.38	112	79	No	+42	Wastewater transmitted to Ocean Reef Club. Effluent disposal by shallow injection wells for individual study areas. For combinations Florida Statute requires effluent disposal by deep injection wells. Deep injection wells increase annual costs by \$438,000, or about \$2/EDU/Mo.
17, 18, 19, 20, 21, 22, 23, 24 Upper Matecumbe, Windley, Plantation, Tavernier (PAED 15), Rock Harbor PAED 16, PAED 17, PAED 18, PAED 19/20	3.35	68	77	Yes	-12	Wastewater Treatment Plant within service area. Effluent disposal by shallow injection wells for individual study areas. For combinations Florida Statute requires effluent disposal by deep injection wells. Deep injection wells increase annual costs by \$468,000, or about \$2/EDU/Mo.

(1) Weighted study area monthly cost per EDU is calculated as the sum of products of the monthly cost per EDU for the study area times the EDUs for the study area, divided by the sum of the EDUs for all study areas being combined.

(2) For purposes of comparing alternatives, costs are considered significantly different if they differ by more than 10 percent. If costs are within 10 percent, they are considered the same.

(3) (-) denotes savings by combining
(+) denotes additional cost by combining

Memo

To: KLWTD Board
From: Carol Walker, CMC
CC: Staff
Date: October 5, 2005
Re: TAB 2

The attached is the pending payments list for October 5, 2005 TAB 2

Key Largo Wastewater Treatment District

Payments Pending 10/05/05

Prepared 10/03/05

CONSOLIDATED CASH BALANCE FORWARD

\$ 629,404.94

Administration & Operations

Cash Balance A&O Account Forward	\$ 96,194.70	
Plus: MSTU Draw #11	45,334.25	
Less: BellSouth - Rollover Lines & Office Line	110.28	
Sprint - Cell Phones	153.27	
PRMG - SRF Loan Appl. & Misc.	749.13	
GSG - Assessment Roll Development	450.00	
FMIT - Quarterly Insurance Premium	12,306.00	
Upchurch, W, W & M - Mediation Fee	2,433.33	
MC Court Reporters - Haskell Settlement Meeting	137.50	
Heidi Herzog - Clerk Vacation Coverage	277.50	
Toshiba - Copier Expense	468.79	
Chris Sante - Office Rent (October)	2,450.00	
Comcast - Cable Service	31.28	
Office Depot - MS Office (2@\$500), Printer (\$300), Misc.	2,963.88	
Nissan - Truck Lease	219.00	
Tom Dillon - Legal Services	1,281.50	
Premier Global Service - CPH Conference Calls (2)	93.86	
Federal Express - Deliveries	226.57	
VISA - Pipe Insp. Camera (\$6,500), Fuel, Misc.	7,819.17	
Paychex - September Fee	100.12	
FKEC - Office Electric (3 mos. "B" / 1 mo. "A")	619.00	
Sub-total Invoices	32,890.18	
		\$ 12,444.07
Cash Balance A&O Account If All Paid	\$ 108,638.77	
Memo: MSTU Draw #12 Submitted 9/7/05 \$65,288		

Key Largo Park

Cash Balance KLP Account Forward	\$ (32,878.93)	
Less: Weiler Engineering - September	3,022.29	
		(3,022.29)
Cash Balance KLP Account If All Paid	\$ (35,901.22)	
Memo: MC Cesspit Draw #1 Submitted 7/22/05 \$ 17,464		

Key Largo Trailer Village

Cash Balance KLTV Account Forward	\$ (422,622.20)	
Less: Tom Dillon - Legal Services	6,788.00	
Weiler Engineering - September	5,656.78	
Haskell - August	367,282.77	
Sub-total Invoices	379,727.55	
		(379,727.55)
Cash Balance KLTV Account If All Paid	\$ (802,349.75)	
Memo: FEMA Draw #8 Submitted 7/20/05 \$ 933,518		
DCA Cesspit Draw #1 Submitted 7/22/05 \$ 654,049		
FEMA Draw #9 (Final) Submitted 8/02/05 \$ 8,373		

North Key Largo Development

Cash Balance KLNC Account Forward	988,711.37	
Less: Tom Dillon - Legal Services	994.00	
Weiler Engineering - September	2,583.15	
		(3,577.15)
Cash Balance KLNC Account If All Paid	985,134.22	

CONSOLIDATED CASH BALANCE IF ALL PAID

\$ 255,522.02

NOTE: A TOTAL OF \$ 1,678,692 REQUESTED FOR REIMBURSEMENT IS OUTSTANDING

Approved for payment:

Charles Brooks, Chairman

Andrew Tobin, Secretary

P.O. Box 491 Key Largo, FL 33037
Phone: 305-453-5804
Fax: 305-453-5807

**Key Largo
Wastewater
Treatment District**

Memo

To: KLWTD Board
From: Carol Walker, CMC
CC: Staff
Date: October 5, 2005
Re: TAB 2 and TAB 3

The attached is additional information for TAB 3 and TAB 4

Commercial Connections Along US-1 Corridor

Includes hotels, RV parks, Trailer Parks, Marinas, Etc. that have existing WWTPs and collection system.

1383 EDUs (based on flow, where 167 GPD = 1 EDU)

- This represents the minimum number of EDUs. Actual number of EDUs will be larger, depending on definitions adopted by KLWTD. Could be as much as double this number.

Summary

		SBR	ENH ² SBR	
■ WWTP site costs -	\$17.6 M	15.2	742,000	5%
■ Force Main costs -	\$4.8 M		208,000	4.3%
■ Lake Surprise area -	\$6.8 M		579,000	4.6%
■ Largo Gardens area -	\$4.5 M		239,000	6.4%
■ Design & Permitting -	\$1.8 M			
		31.3M	1.7M	5.4%

TOTAL: \$35.5 M

Note: A 15% (\$5 M) contingency fund on construction costs should be budgeted

Memo

To: KLWTD Board
From: Carol Walker, CMC
CC: Staff
Date: October 5, 2005
Re: TAB 3

The attached is the maps that are referred to in the Collection System Design Scope Section 1 – General on page 1 of the additional information for TAB 3 in your Info Package.

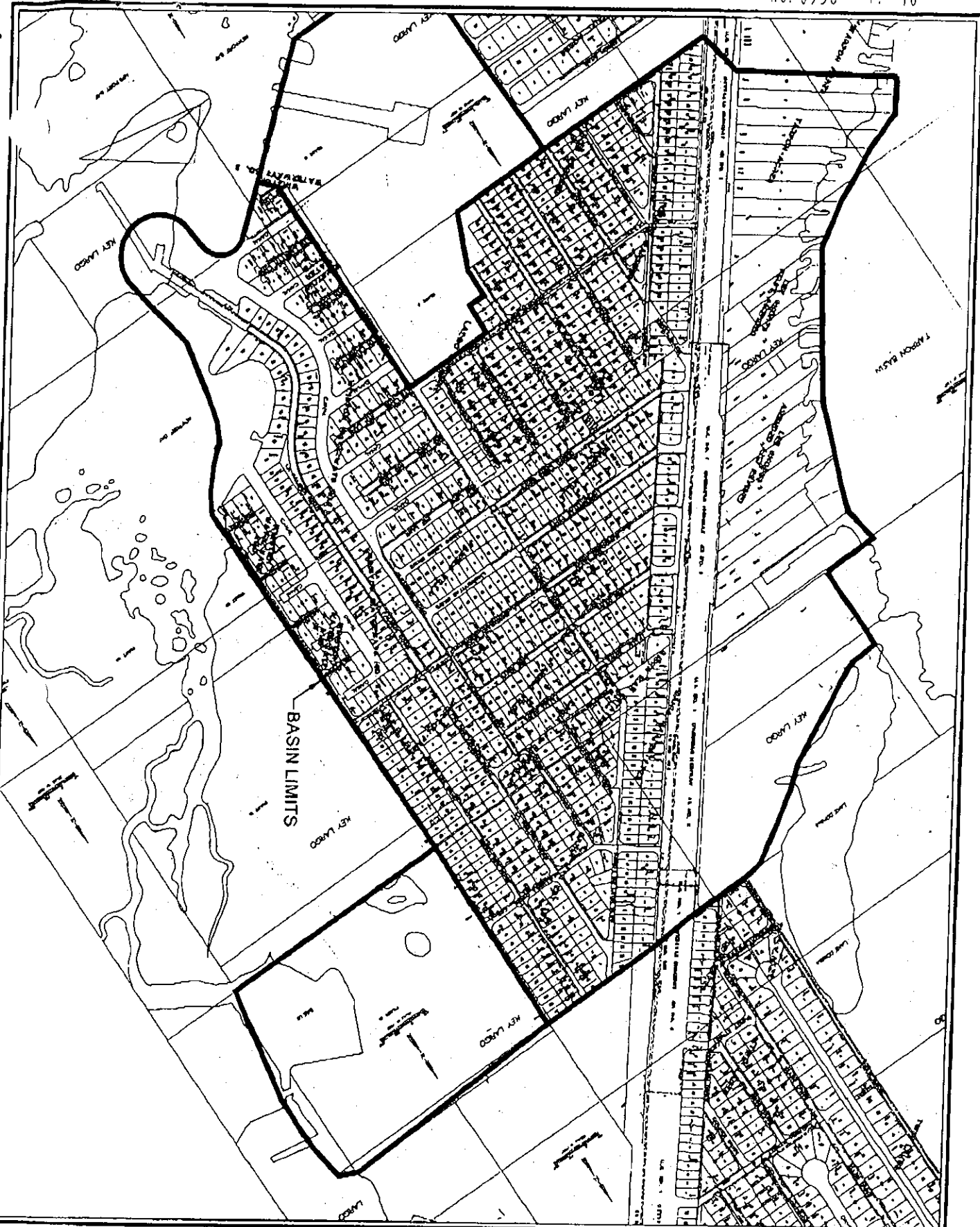

CPH
 Engineers
 Surveyors
 Planners/Landscape Architects
 Environmental Scientists
 Construction Management
 www.cphengineers.com
 1117 East Robinson Street, Orlando, FL 32801
 Phone 407.426.0852 Fax 407.948.3036

Scale: 1" = 700'
 Date: 08-01-2005
 Job No.: K3001
 Certificate of Authorization
 No. 3213

BASIN MAP
CLIENT
KEY LARGO FM AND LIFT STATION

© 2004
FIGURE
1

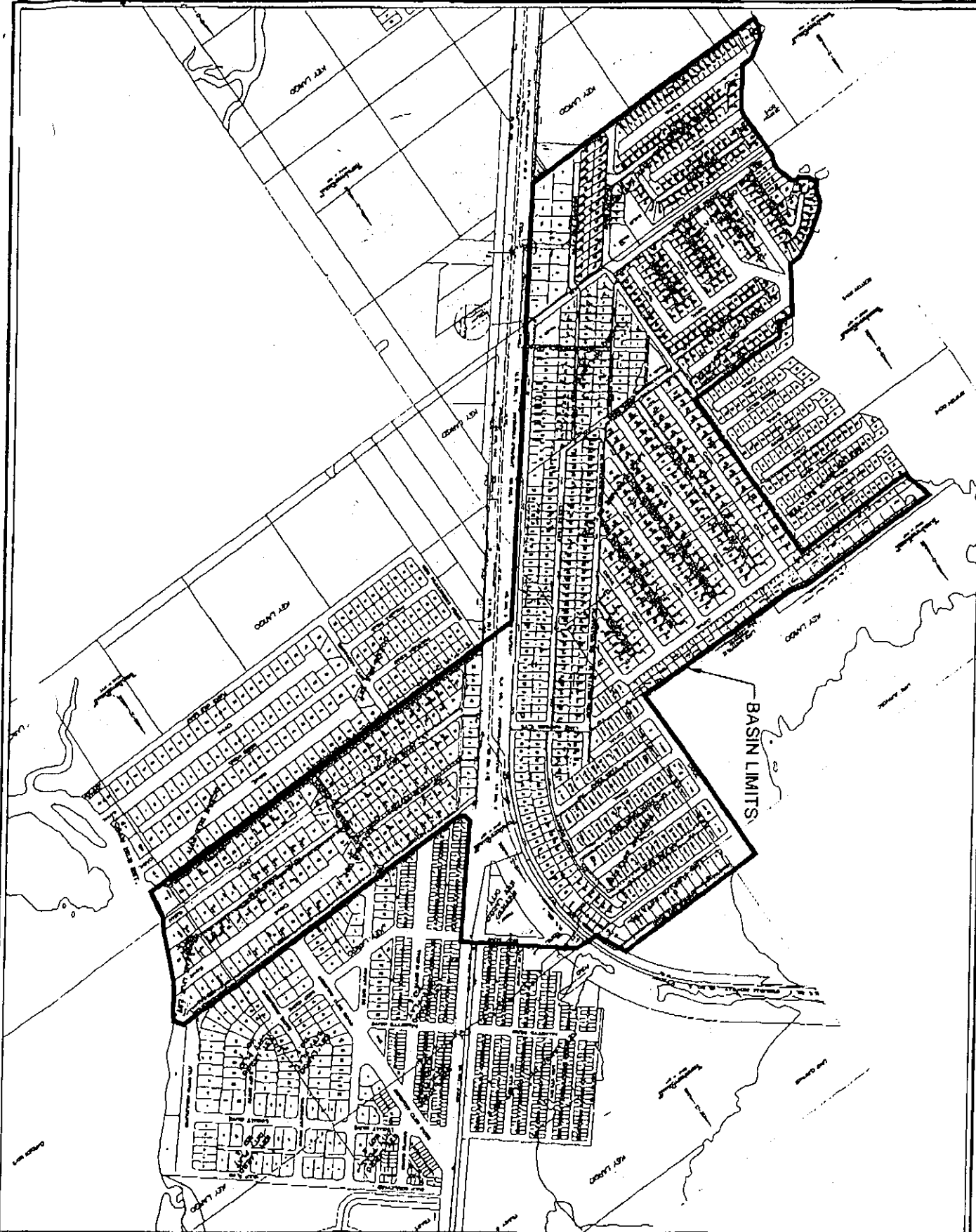

oph Engineers
 Surveyors
 Planners / Landscape Architects
 Environmental Scientists
 Construction Management

1010 W. CPH ENGINEERS, S.C.
 1117 East Robinson Street, Orlando, FL 32803
 Phone 407.425.0452 Fax 407.646.1936

Scale: 1" = 800'
 Date: 08-01-2005
 Job No.: K3001
 Certificate of Authorization
 No. 3215

BASIN MAP

CLIENT
KEY LARGO FM AND LIFT STATION

FIGURE
2

Memo

To: KLWTD Board
From: Carol Walker, CMC
CC: Staff
Date: October 5, 2005
Re: TAB 4

Please see attached additional information for TAB 4.

the services provided; if the services consist of a meeting or phone call, the names of the other participants; the time spent, rounded up to the nearest 0.1 hour. The District shall review and pay all invoices in accordance with applicable provisions of the Florida Prompt Payment Act (Section 218.70, *et seq.* Fla. Stat.).

5. Arcadis certifies that wage rates and other factual unit costs supporting the rates in Proposal Schedule B – Attachment C are accurate, complete, and current as of the date of the Proposal. The original contract price and any additions thereto will be adjusted to exclude any significant sums by which the District determines the contract price was increased due to inaccurate, incomplete, or noncurrent wage rates and other factual unit costs. All such contract adjustments must be made within 1 year following the end of the project.

IN WITNESS WHEREOF, the parties have executed this Work Authorization No. 1 on the dates opposite their names.

Arcadis G&M, Inc.

By: _____

Date: _____

Name: _____

Its: _____

Key Largo Wastewater Treatment District

By: _____

Date: _____

Name: Charles Brooks

Its: Chairman

By: _____

Name: Andrew Tobin

Its: Secretary

Attest

District Counsel Endorsement

By: _____

Name: Carol Walker

Its: District Clerk

By: _____

Name: Thomas M. Dillon

Its: District Counsel

the services provided; if the services consist of a meeting or phone call, the names of the other participants; the time spent, rounded up to the nearest 0.1 hour. The District shall review and pay all invoices in accordance with applicable provisions of the Florida Prompt Payment Act (Section 218.70, *et seq.* Fla. Stat.).

5. ARCADIS certifies that wage rates and other factual unit costs supporting the rates in Proposal Schedule B – Attachment C are accurate, complete, and current as of the date of the Proposal. The original contract price and any additions thereto will be adjusted to exclude any significant sums by which the District determines the contract price was increased due to inaccurate, incomplete, or noncurrent wage rates and other factual unit costs. All such contract adjustments must be made within 1 year following the end of the project.

IN WITNESS WHEREOF, the parties have executed this Work Authorization No. 1 on the dates opposite their names.

ARCADIS G&M, Inc.

By: William H. Lynch

Date: _____

Name: William H. Lynch, PE

Its: Vice President

Key Largo Wastewater Treatment District

By: _____

Date: _____

Name: Charles Brooks

Its: Chairman

By: _____

Name: Andrew Tobin

Its: Secretary

Attest

District Counsel Endorsement

By: _____

Name: Carol Walker

Its: District Clerk

By: _____

Name: Thomas M. Dillon

Its: District Counsel

WORK AUTHORIZATION NUMBER 1

Under

Key Largo Wastewater Treatment District Consulting Agreement

With

ARCADIS G&M, Inc.

THIS WORK AUTHORIZATION NUMBER 1 is issued under and pursuant to that certain consulting agreement by and between the Key Largo Wastewater Treatment District ("District") and ARCADIS G&M, Inc. ("ARCADIS"), dated December 9, 2003.

WHEREAS, the District and ARCADIS entered into a master consulting agreement dated December 9, 2003 ("Consulting Agreement"), and

WHEREAS, in accordance with the Consultants' Competitive Negotiation Act, Section 287.055, Fla. Stat. ("CCNA"), the District in 2005 issued requests for Statements of Qualifications of interested consultants with respect to the design of a new wastewater treatment plant and associated facilities ("the Project"), and

WHEREAS, after consideration of the statements of qualifications received from interested consultants, the District selected ARCADIS as the highest ranked firm for the Project, and

WHEREAS, the District and ARCADIS have negotiated a contract at compensation that the District believes to be fair, competitive, and reasonable after analysis of the cost of the professional services required as well as their scope and complexity;

NOW THEREFORE, in consideration of the premises and in further consideration of the promises below, the District does hereby authorize ARCADIS to proceed with the work described in the attached proposal, dated September 30, 2005 ("Proposal"), subject to the following terms and conditions:

1. The work shall be conducted under and in accordance with the consulting agreement dated December 9, 2003, as the same has been amended, except as expressly provided herein.
2. The basis of compensation for the work shall be the unit rates provided in the Proposal Schedule B – Attachment C, subject to a not-to-exceed amount of \$742,400.00 for the Project. The parties acknowledge and agree that the amounts of time shown for various tasks and subtasks in Proposal Schedule B – Attachment C, are estimates, only, and that actual time spent on the various tasks and subtasks will likely vary from the amounts shown. However, in no event will that total compensation to ARCADIS exceed \$742,400 without the District's prior written authorization.
3. To the extent that any provision of the Consulting Agreement is inconsistent with this Work Authorization, such provision shall not apply to this Project. Without limiting the generality of the foregoing, to the extent that Schedule B to the Consulting Agreement provides or implies that any work performed by ARCADIS shall be compensated on a lump sum basis, said Schedule B shall not apply to this Project.
4. ARCADIS shall invoice the District on a monthly basis for work performed during the preceding month. All invoices will be supported by narrative time sheets listing, with respect to each block of time: the name of the person providing the services; a brief description of

WORK AUTHORIZATION NUMBER 1

Under

Key Largo Wastewater Treatment District Consulting Agreement

With

Arcadis G&M, Inc.

THIS WORK AUTHORIZATION NUMBER 1 is issued under and pursuant to that certain consulting agreement by and between the Key Largo Wastewater Treatment District ("District") and Arcadis G&M, Inc. ("Arcadis"), dated December 9, 2003.

WHEREAS, the District and Arcadis entered into a master consulting agreement dated December 9, 2003 ("Consulting Agreement"), and

WHEREAS, in accordance with the Consultants' Competitive Negotiation Act, Section 287.055, Fla. Stat. ("CCNA"), the District in 2005 issued requests for Statements of Qualifications of interested consultants with respect to the design of a new wastewater treatment plant and associated facilities ("the Project"), and

WHEREAS, after consideration of the statements of qualifications received from interested consultants, the District selected Arcadis as the highest ranked firm for the Project, and

WHEREAS, the District and Arcadis have negotiated a contract at compensation that the District believes to be fair, competitive, and reasonable after analysis of the cost of the professional services required as well as their scope and complexity;

NOW THEREFORE, in consideration of the premises and in further consideration of the promises below, the District does hereby authorize Arcadis to proceed with the work described in the attached proposal, dated September 30, 2005 ("Proposal"), subject to the following terms and conditions:

1. The work shall be conducted under and in accordance with the consulting agreement dated December 9, 2003, as the same has been amended, except as expressly provided herein.
2. The basis of compensation for the work shall be the unit rates provided in the Proposal Schedule B – Attachment C, subject to a not-to-exceed amount of \$742,400.00 for the Project. The parties acknowledge and agree that the amounts of time shown for various tasks and subtasks in Proposal Schedule B – Attachment C, are estimates, only, and that actual time spent on the various tasks and subtasks will likely vary from the amounts shown. However, in no event will that total compensation to Arcadis exceed \$742,200 without the District's prior written authorization.
3. To the extent that any provision of the Consulting Agreement is inconsistent with this Work Authorization, such provision shall not apply to this Project. Without limiting the generality of the foregoing, to the extent that Schedule B to the Consulting Agreement provides or implies that any work performed by Arcadis shall be compensated on a lump sum basis, said Schedule B shall not apply to this Project.
4. Arcadis shall invoice the District on a monthly basis for work performed during the preceding month. All invoices will be supported by narrative time sheets listing, with respect to each block of time: the name of the person providing the services; a brief description of

Memo

To: KLWTD Board
From: Carol Walker, CMC
CC: Staff
Date: October 5, 2005
Re: TAB 5

The attached is the status report from Weiler Engineering for TAB 5.

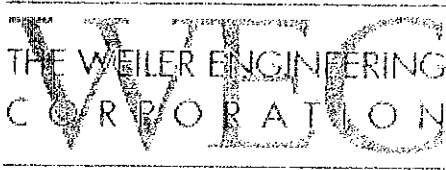

"Excellence in Engineering"

20020 Veterans Boulevard., Suite 7
Port Charlotte, FL 33954
(941) 764-6447 ph
(941) 764-8915 fax

Key Largo Wastewater Treatment District Engineering Status Report Period Ending 09/30/05

Key Largo Park

Trenching continued in the Key Largo Park and vacuum main was placed on Lauderdale Drive. ADB brought in a sub, Pabone Engineering, to excavate and lay pipe.

The new style Airvac pits were received. Bill Mouldin, the Airvac field representative, arrived for his four week service period. Clint Hawn of Airvac also came down to observe the new style pits being installed. One was installed, but several failed the pre-placement pressure test and a number of others failed visual inspection by the Airvac representatives. Installation of the new pits was put on hold while the problem is being investigated. Installation of the old style pits is being carried on.

Key Largo Trailer Village

Cleanup and restoration continued in September. The transition from the HDPE pipe used in the US 1 crossing to the PVC used throughout the rest of the project was accomplished and the run of three 10-inch pipes from US 1 into the vacuum tank at the WWTP site began.

KLTV Treatment Plant

Work at the treatment plant progressed with the piping in of the vacuum pump skid and other components of the vacuum pump station. Coatings were applied to the administration/motor control center building. The electrical and plumbing work progressed throughout the month.

Ted Hortenstine of Brown and Caldwell worked on the wastewater treatment plant Operation and Maintenance Manual in September. He has the Fluidyne and miscellaneous equipment information in hand and was expecting delivery of the Airvac manuals shortly. He is also contacting the Florida Rural Water Association to request a copy of their guidance document for preparation of Operation and Maintenance Manuals.

Submittals for coatings and miscellaneous deliverables were received in September. WEC pointed out the Brown and Caldwell that the anchors for the Fluidyne tanks needed to be designed for the combined wind and buoyancy loads rather than each one separately. As a result, the anchors are being beefed up. The new anchors will be galvanized as specified for the miscellaneous metals rather than epoxy coated as proposed.

Lake Surprise Project

Design of the north component force main progressed in September. Several conference calls were held with CPH staff, District staff and WEC staff. CPH continued the hydraulic modeling of the force main system. The 30% design of the force main was submitted at the end of September and is currently under review by WEC and District staff.

The CPH proposal for the design of the collection systems for the Lake Surprise basin and the Largo Gardens basin was revised and pricing was negotiated. An acceptable scope and price for the design of the tow collection basins was reached and is recommended for approval. The pricing for the survey was too high, and that pricing is still under negotiation.

Through several conferences with Arcadis, MWH, WEC and District staff, the scope of work for the design and permitting of the wastewater treatment plant achieved an acceptable degree of detail. Both specific technical assumptions and level of effort by the designers was submitted. The position of Arcadis/MWH has been that they can not accurately provide their pricing until further details of the work are designed. After consultations with all parties and with District Counsel, it was decided to change the form of the proposed work authorization to an hourly task with a not-to-exceed total. It was also agreed that after the conceptual design stage was completed, the not-to-exceed pricing would be revisited with the intent of looking for reductions in cost.

Haskell Pay Applications

Payment of Haskell Pay Application No. 23 was submitted in September, but a number of adjustments were needed. As a result, the application was not approved by WEC until the end of the month. Pay Application No. 23 is now complete and will be submitted on the Payments Pending list for the October 3rd Board meeting.

Regulatory Compliance Issues

The Environmental Resources Permit has been provided to WEC. With the exception of final certifications and approval for use, this should complete the permitting processes.

Project Team Meetings and Actions

Ed Castle attended the scheduled Board meetings on September 7th and 21st. He also met with KLWTD staff on those dates prior to the Board meetings. He also attended the construction progress meetings for Key Largo Park on and also attended the weekly District Staff meetings either in person or by telephone. He also attended design review conference calls with CPH and District staff.

Ed Castle and Dave Gile of WEC performed construction inspection throughout the period.